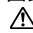

EXPLODED VIEW & PARTS LIST

NOTES

- PC boards shown are viewed from parts side.
- Parts marked with * require longer delivery time.
- The parts with no reference number or no parts number in the exploded views are not supplied.
- As regards the resistors and capacitors, refer to the circuit diagrams contained in the manual.
-  Parts marked with this sign are safety critical components. They must be replaced with identical components – refer to the appropriate parts list and ensure exact replacement.
- Parts of [] mark can be used only with the version designated.
[J]: JAPAN [US]: U.S.A. [C]: CANADA [K]: KOREA
[E]: EUROPE [A]: AUSTRALIA [GE]: GENERAL EXPORT

注意

- プリント基板は部品面が示されています。
- * 印の部品は納期が若干かかります。
あらかじめご了承ください。
- 分解図に部番のない部品及び品番のない部品は供給しません。
- 標準の抵抗、コンデンサーは省略してあります。
回路図を参照してください。
-  は安全重要部品です。
交換する時は必ずティアック指定の部品を使用してください。
- 仕向先
[J]: JAPAN [US]: U.S.A. [C]: CANADA [K]: KOREA
[E]: EUROPE [A]: AUSTRALIA [GE]: GENERAL EXPORT

EXPLODED VIEWS AND PARTS LIST

EXPLODED VIEW-1

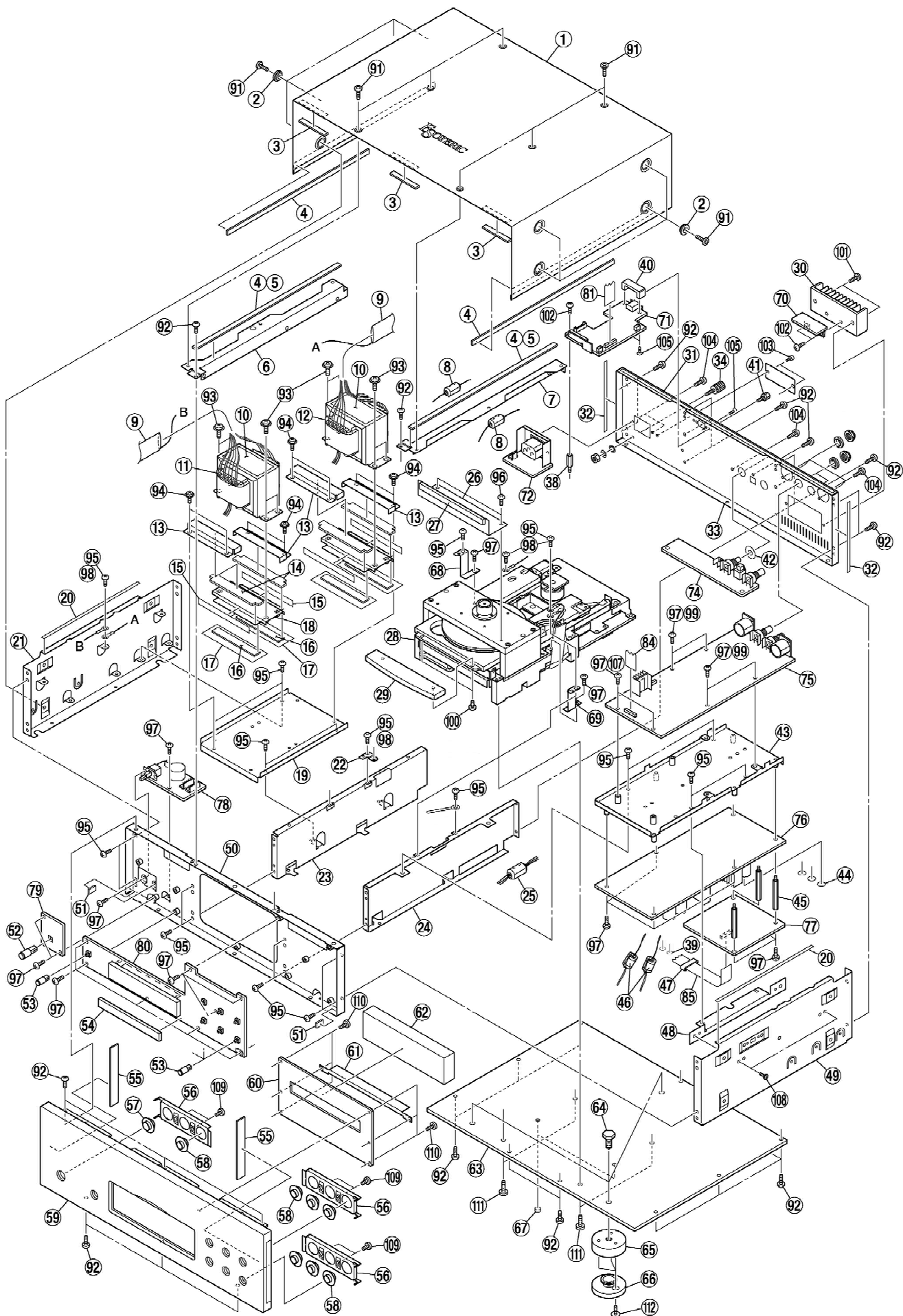

EXPLODED VIEW-1

| REF. NO. | PARTS NUMBER | DESCRIPTION | REMARKS |
|----------|--------------|---------------------------|-----------------------|
| 1-1 | M01981110A | BONNET,EXP X-03 | |
| 1-2 | M01969500A | COLLAR,SCREW 2.3 S | |
| 1-3 | M01939600A | GASKET,E02S080030ET/50MM | |
| 1-4 | M02213800A | GASKET,E02S100030ET/280 | EXP |
| 1-4 | M02213800A | GASKET,E02S100030ET/280 | |
| 1-5 | M02114500A | CUSHION,PORON T3 280*10 | |
| 1-6 | M01766700B | FRAME,TOP L X-01 | DM |
| 1-6 | M01766710A | FRAME,TOP L EXP X-01 | EXP |
| 1-7 | M01766800B | FRAME,TOP R X-01 | DM |
| 1-7 | M01766810A | FRAME,TOP R EXP X-01 | EXP |
| 1-8 | E0096620 | CORE,E04SR130525AB BLACK | |
| 1-9 | M02098900A | SHRINK SHIELD, 30X400 | |
| 1-10 | M02049801A | LABEL,TRANS SILVER ESO | |
| 1-11 | E00987900B | TRANS,ANALOG UX-3 | DM |
| 1-11 | E00987920A | TRANS,ANALOG UX-3 T/C | T/C |
| 1-11 | E00987950A | TRANS,ANALOG UX-3 EUR | EUR/KOR |
| 1-12 | E00987800B | TRANS,DIGITAL UX-3 | DM |
| 1-12 | E00987820A | TRANS,DIGITAL UX-3 T/C | T/C |
| 1-12 | E00987850A | TRANS,DIGITAL UX-3 EUR | EUR/KOR |
| 1-13 | M02049500A | BRACKET,TRANS(B) UX-3 | DM |
| 1-13 | M02049510A | BRACKET,TRANS(B) EXP UX-3 | EXP |
| 1-14 | M02096200A | RUBBER SHEET,TRANS(B) | |
| 1-15 | M02096900A | TAPE,TEFLON(A) | |
| 1-16 | M02096100A | RUBBER SHEET,TRANS(A) | |
| 1-17 | M02096901A | TAPE,TEFLON(B) | |
| 1-18 | M02049400A | BRACKET,TRANS(A) UX-3 | DM |
| 1-18 | M02049410A | BRACKET,TRANS(A) EXP UX-3 | EXP |
| 1-19 | M02034200A | CHASSIS,TRANS UX-3 | DM |
| 1-19 | M02034210A | CHASSIS,TRANS EXP UX-3 | EXP |
| 1-20 | M02164300A | GASKET,E02F4T/5X190 | |
| 1-21 | M00389301B | CHASSIS,SIDE L UX-1 | DM |
| 1-21 | M00389310B | CHASSIS,SIDE L EXP UX-1 | EXP |
| 1-22 | M02050200A | BRACKET,PCB VIDEO UX-3 | |
| 1-23 | M01724200B | FRAME,L X-01 | DM |
| 1-23 | M01724210A | FRAME,L EXP X-01 | EXP |
| 1-24 | M01724300A | FRAME,R X-01 | DM |
| 1-24 | M01724310A | FRAME,R EXP X-01 | EXP |
| 1-25 | E0096630 | CORE,E04SR170730AB BLACK | |
| 1-26 | M02230800A | COVER,SHIELD UX-3 | |
| 1-27 | M02230700A | 13230T,E02S100040ET/125MM | |
| 1-28 | M01969600A | MECH ASSY,UNIT UX-3 | |
| | E95249900A | PCB ASSY CORE13162PU A-ID | WITH / AIDIO-ID |
| 1-29 | M02033900A | PANEL,TRAY X-03 | |
| 1-30 | M01480700A | HEATSINK,DV-50 | |
| 1-31 | M01939800A | GASKET,E02F4T/5X420 | EXP |
| 1-32 | M02213700A | GASKET,E02F4T/5*120 | EXP |
| 1-33 | M01981000A | REAR PANEL,DM X-03 | DM |
| 1-33 | M01981010A | REAR PANEL,EXP X-03 | EXP |
| 1-34 | E00768700A | TERMINAL,GND D12 | |
| 1-38 | M0205000 | SPACER,BSB-320 | |
| 1-39 | M02125100A | SHEET,SHIELD(CU)-6 | SHEET, COPPER (SMALL) |
| 1-40 | M02034300A | HOLDER,1394JACK UX-3 | |
| 1-41 | M02116000A | SPACER,TBSB-2505.8 | |
| 1-42 | M01259600A | POLYEST WSHR,10.5*20*0.2T | |
| 1-43 | M02034100A | BRACKET,PCB UX-3 | DM |
| 1-43 | M02034110A | BRACKET,PCB EXP UX-3 | EXP |
| 1-44 | M01571300A | SHEET,SHIELD(CU)-10 | |
| 1-45 | M0205010 | SPACER,BSB-348 | |
| 1-46 | E0047010 | CORE,E04SR150718 | |
| 1-47 | E0096950 | CORE,E04FG221308 | |
| 1-48 | M02034500A | BRACKET,SIDE UX-3 | DM |
| 1-48 | M02034510A | BRACKET,SIDE EXP UX-3 | EXP |
| 1-49 | M02034400A | CHASSIS,SIDE R UX-3 | DM |
| 1-49 | M02034410A | CHASSIS,SIDE R EXP UX-3 | EXP |
| 1-50 | M01724100B | CHASSIS,FRONT X-01 | DM |
| 1-50 | M01724110A | CHASSIS,FRONT EXP X-01 | EXP |
| 1-51 | M02107800A | CUSHION,PORON T3 13*8 | |
| 1-52 | M01723600A | BUTTON,D10 X-01 | |
| 1-53 | M01723500A | BUTTON,D8 X-01 | |
| 1-54 | M01838900B | RUBBER SH,PORON T5 135*15 | |

EXPLODED VIEW-1

| REF. NO. | PARTS NUMBER | DESCRIPTION | REMARKS |
|----------|--------------|---------------------------|---------|
| 1-55 | M01717600B | CUSHION,PORON T3 105*12 | |
| 1-56 | M01723900A | BRACKET,LENS X-01 | |
| 1-57 | M01723800A | LENS,D10 X-01 | |
| 1-58 | M01723700A | LENS,D8 X-01 | |
| 1-59 | M01981500A | FRONT PNL ASSY,X-03 | |
| 1-60 | M02101400A | WINDOW,FRONT UX-3 | |
| 1-61 | M01723400A | PLATE,BLIND X-01 | |
| 1-62 | M01777600A | CUSHION,FOAM FRONT | |
| 1-63 | M01724600A | PLATE,BOTTOM X-01 | |
| 1-64 | M01494802A | FOOT,(A) HEX 15 | DM |
| 1-64 | M01494805A | FOOT,(A) HEX 15 EXP | EXP |
| 1-65 | M01495001A | STAND,FOOT 13 | DM |
| 1-65 | M01495002A | STAND,FOOT 13 EXP | EXP |
| 1-66 | M01494901A | FOOT,(B) 11 | DM |
| 1-66 | M01494902A | FOOT,(B) 11 EXP | EXP |
| 1-67 | M01847300A | RUBBER SH,D9*T2 PORON | |
| 1-68 | M02032900A | BRACKET,MECHA L UX-3 | |
| 1-69 | M02033000A | BRACKET,MECHA R UX-3 | |
| 1-70 | E95182400A | PCB ASSY,REG | |
| 1-71 | E95229900A | PCB ASSY,1394 BVF | |
| 1-72 | E95232500A | PCB ASSY,INLET UX-3 | |
| 1-74 | E95182100A | PCB ASSY,D-OUT | |
| 1-75 | E95223900A | PCB ASSY,DAC X-03 | DM |
| 1-75 | E95223910A | PCB ASSY,DAC EXP X-03 | EXP |
| 1-76 | E95233300A | PCB ASSY,POWER X-03 | DM |
| 1-76 | E95233320A | PCB ASSY,POWER X-03 T/C | T/C |
| 1-76 | E95233350A | PCB ASSY,POWER X-03 EUR | EUR/KOR |
| 1-77 | E95231600A | PCB ASSY,DATA JCT | |
| 1-78 | E95232400A | PCB ASSY,PSW UX-3 | DM |
| 1-78 | E95232420A | PCB ASSY,PSW UX-3 T/C | T/C |
| 1-78 | E95232450A | PCB ASSY,PSW UX-3 EUR | EUR/KOR |
| 1-79 | E95233800A | PCB ASSY,PWRLED UX-3 | |
| 1-80 | E95232700A | PCB ASSY,FRONT X-03 | |
| 1-81 | E01017700A | FLAT CABLE,JCT-1394 UX GN | |
| 1-84 | E01017800A | FLAT CABLE,JCT-DAC2 UX GN | |
| 1-85 | E01017500A | FLAT CABLE,CORE-JCT UX GN | |
| 1-91 | 5801532510 | SCREW,HEXAGON 3*8SILVER | |
| 1-92 | B00170908A | SCREW,VPBR 3*8 FZB G | |
| 1-93 | B00197708A | SCREW,PPSU 4*8 FZB G | |
| 1-94 | B00173006A | SCREW,PPS 3*6 FZB G | |
| 1-95 | B00170808A | SCREW,VPB 3*8 FZB G | |
| 1-96 | B00168906A | SCREW,VPA 3*6 FZB G | |
| 1-97 | B00170506A | SCREW,VPC 3*6 FZB G | |
| 1-99 | B00237806A | SCREW,VPA 3*6FCU | |
| 1-100 | 5780013003 | SCREW,BPA 3*3 FNI | |
| 1-101 | B00172010A | SCREW,PPA 2.6*10 FZB G | |
| 1-102 | B00170508A | SCREW,VPC 3*8 FZB G | |
| 1-103 | 5781702606 | BOLT, H.S. M2.6X6(NI) | |
| 1-104 | B00170608A | SCREW,VPCR 3*8 FZB G | |
| 1-105 | B00200105A | SCREW,FPA 2.5*5FNI | |
| 1-107 | B00239406A | SCREW,BPA 3*6FCU | |
| 1-108 | B00171104A | SCREW,DPA 3*4 FZB G | |
| 1-109 | 5780003004 | SCREW,BPA 3*4 FZC | |
| 1-110 | B00174006A | SCREW,BPA 3*6 FZC G | |
| 1-111 | B00171508A | SCREW,BPA 4*8 FZB G | |
| 1-112 | B00171006A | SCREW,PPAU 3*6 FZB G | |

FRONT PCB ASSY

| REF. NO. | PARTS NUMBER | DESCRIPTION | REMARKS |
|-------------|--------------|----------------------------|---------|
| | E95232700A | PCB ASSY,FRONT X-03 | |
| | E90181900D | PCB,FRONT | |
| | M00539300A | HOLDER ASSY,FL | |
| | 5801532101 | FL GDE | |
| | M00539400A | CUSHION, | |
| | 5555590000 | PLATE A, GROUNDING | A300 |
| | M0029800 | SPACER,LED LH-3-4 | |
| | M0176070 | HOLDER,LED LF-10 | |
| C1,C3,C4 | 5263167923 | C, FILM 0.10UF 50V J VT | |
| C11,C13,C15 | 5263167923 | C, FILM 0.10UF 50V J VT | |
| C12 | 5263310520 | C, FILM 100PF 50V J VT | |
| C16,C17,C19 | 5263167923 | C, FILM 0.10UF 50V J VT | |
| C2,C14,C18 | 5260462720 | CE, 47UF 25V M AU VT | |
| C20 | 5263167923 | C, FILM 0.10UF 50V J VT | |
| D1,D3 | S0052200 | LED,SLR343BCT3F | |
| D10 | 5224015020 | DIO 1SS133T-77 FT | |
| D18,D19 | S0052200 | LED,SLR343BCT3F | |
| D20 | S0052200 | LED,SLR343BCT3F | |
| D21,D22 | S0052200 | LED,SLR343BCT3F | |
| D23 | S0052200 | LED,SLR343BCT3F | |
| D4,D6 | S0052200 | LED,SLR343BCT3F | |
| D7,D9 | S0052200 | LED,SLR343BCT3F | |
| FL1 | E00746900B | ELCTR N RAY DSPL,CM2058G G | |
| JP4 | 5242117400 | JUMPER (INS) JPW-L5 | |
| JP6 | 5242117400 | JUMPER (INS) JPW-L5 | |
| L1 | 5286033920 | CHC 10UH K(LAP2T)VT | |
| P1 | 5336253700 | CONN PL B07B-PH-K-Y | |
| P10 | 5336249800 | CONN PL B08B-PH-K-S W | |
| P2 | 5336249900 | CONN PL B09B-PH-K-S W | |
| P3 | E0085664 | CONNECTOR,10FLT-SM1-TB | |
| P4 | 5336250000 | CONN PL B10B-PH-K-S W | |
| P5,P7 | 5336249300 | CONN PL B03B-PH-K-S W | |
| P6 | 5336255900 | CONN PL B09B-PH-K-K BK | |
| Q1-Q5 | 5232255620 | DTR DTC114ESA | |
| Q6 | 5232255620 | DTR DTC114ESA | |
| Q7 | 5232254720 | DTR DTA114ESA | |
| R1,R2,R11 | R0101341 | RD, 1/4W 10KOHM J | |
| R12 | R0101101 | RD, 1/4W 1.0KOHM J | |
| R13 | R0101121 | RD, 1/4W 1.2KOHM J | |
| R14 | R0101141 | RD, 1/4W 1.5KOHM J | |
| R15 | R0101181 | RD, 1/4W 2.2KOHM J | |
| R16 | R0101221 | RD, 1/4W 3.3KOHM J | |
| R17-R19 | R0100941 | RD, 1/4W 220 OHM J | |
| R20 | R0101461 | RD, 1/4W 33KOHM J | |
| R22 | R0101441 | RD, 1/4W 27KOHM J | |
| R23 | R0101501 | RD, 1/4W 47KOHM J | |
| R24,R32 | R0101341 | RD, 1/4W 10KOHM J | |
| R25 | R0100941 | RD, 1/4W 220 OHM J | |
| R26 | R0100941 | RD, 1/4W 220 OHM J | |
| R27,R41 | R0101341 | RD, 1/4W 10KOHM J | |
| R28 | R0100941 | RD, 1/4W 220 OHM J | |
| R29 | 5242117400 | JUMPER (INS) JPW-L5 | |
| R33-R38 | R0100781 | RD, 1/4W 47 OHM J | |
| R39,R40 | R0100701 | RD, 1/4W 22 OHM J | |
| R3-R10 | R0100781 | RD, 1/4W 47 OHM J | |
| SW1-SW7 | E0082440 | SW,TACT SKHHDGA010 | |
| U1 | S00590600D | IC,MPU FRONT UX-3 V2.03 | |
| U2 | S0051434 | IC,BR93L46RF-W | |
| U3 | S0021414 | IC,TC74VHCT04 | |
| U4 | S0018723 | & IC,M66004FP | |
| U5 | S0053230 | IC,RPM7238-H91 | |
| U6 | S0051390 | IC,NJU7223F33 | |
| U7 | S0047794 | FC,TC74VHCT08AF | |
| U8 | S0057054 | IC,M62705ML GXX | |
| X1 | E0022490 | RESONATOR,EFO-EC5004A4 | |

PWRLED PCB ASSY

| REF. NO. | PARTS NUMBER | DESCRIPTION | REMARKS |
|----------|--------------|-------------------------|---------|
| | E95233800A | PCB ASSY,PWRLED UX-3 | |
| | E90182000A | PCB,PWRLED | |
| D15,D16 | S0052200 | LED,SLR343BCT3F | |
| D24 | S0052200 | LED,SLR343BCT3F | |
| P9 | 5336249300 | CONN PL B03B-PH-K-S WHT | |
| Q10 | 5232255620 | DTR DTC114ESA | |
| R31 | R0100941 | RD, 1/4W 220 OHM J | |

D-OUT PCB ASSY

| REF. NO. | PARTS NUMBER | DESCRIPTION | REMARKS |
|-------------|--------------|---------------------------|---------|
| | E95182100A | PCB ASSY,D-OUT | |
| | E90182100B | PCB,D-OUT | |
| | M01650800A | WASHER,JACK BNC | |
| | M01650900A | NUT,JACK BNC | |
| | 13180156 | TERM (P-424) | |
| | 5780202606 | SCREW, FLAT M2.6X6 | |
| C1001,C1003 | 5263167923 | C, FILM 0.10UF 50V J VT | |
| C1002,C1007 | C0007510 | CE, 16V 47UF M SA | |
| C1004 | 5260462220 | CE, 33UF 25V M AU VT | |
| C1005,C1006 | 5263167923 | C, FILM 0.10UF 50V J VT | |
| C1008 | 5263167923 | C, FILM 0.10UF 50V J VT | |
| J1002 | E00856700A | JACK,RCA 1P ORG NICKING | |
| J1003 | E00831900A | JACK,BNC GOLD | |
| P1003 | 5336249400 | CONNECTORPLUG B04B-PH-K-S | |
| P1004 | 5336251200 | CONN PL B02B-PH-K-R R | |
| R1001 | R0100861 | RD, 1/4W 100 OHM J | |
| R1002 | R0100831 | RD, 1/4W 75 OHM J | |
| T1001 | 5320046300 | TRANSE, PULS TC-1027-04 | |
| U1001 | 5220093600 | IC DGTL TC74HCU04AF-TP2 | |
| U1002-U1004 | E0100982 | FILTER,100PF | |
| U1005 | E0110220 | OPT CONN,GP1FA513TZ0F GZX | |

POWER PCB ASSY

| REF. NO. | PARTS NUMBER | DESCRIPTION | REMARKS |
|---------------|--------------|---------------------------|---------|
| | E95233300A | PCB ASSY,POWER X-03 | |
| | E95233320A | PCB ASSY,POWER X-03 T/C | |
| | E95233350A | PCB ASSY,POWER X-03 EUR | |
| | E90182300A | PCB,POWER | |
| C04-C07 | C0044460 | CQ,100V 0.012UF J DTG GZ0 | |
| C08-C10 | C0042640 | CE, 25V 4700UF M HE | |
| C11,C12 | C0040910 | CE, 35V 3300UF M LXZ | |
| C14,C16 | 5263167923 | C, FILM 0.10UF 50V J VT | |
| C17-C20 | 5260531420 | CE, 100UF 20V M SA VT | |
| C21,C22 | 5263167923 | C, FILM 0.10UF 50V J VT | |
| C23 | C0040902 | CQ, 100V 0.22UF J VT | |
| C24 | 5260463420 | CE, 100UF 50V M AU VT | |
| C25,C26,C27 | 5260462920 | CE, 47UF 50V M AU VT | |
| C28 | 5260463220 | CE, 100UF 25V M AU VT | |
| C29 | 5260531420 | CE, 100UF 20V M SA VT | |
| C31,C32,C34 | C0044460 | CQ,100V 0.012UF J DTG GZ0 | |
| C35,C36 | C0040910 | CE, 35V 3300UF M LXZ | |
| C40-C42 | C0040910 | CE, 35V 3300UF M LXZ | |
| C43-C45 | 5263167923 | C, FILM 0.10UF 50V J VT | |
| C47-C49 | 5260531420 | CE, 100UF 20V M SA VT | |
| C51,C52 | 5263167923 | C, FILM 0.10UF 50V J VT | |
| C53,C54 | 5260531420 | CE, 100UF 20V M SA VT | |
| C56 | 5260461520 | CE, 10UF 25V M AU VT | |
| C57-C62 | 5263167923 | C, FILM 0.10UF 50V J VT | |
| C65,C66 | 5263167923 | C, FILM 0.10UF 50V J VT | |
| C70-C76 | 5263167923 | C, FILM 0.10UF 50V J VT | |
| C78,C79 | 5263167923 | C, FILM 0.10UF 50V J VT | |
| D01-D08 | S0059311 | DIODE,21DQ10 GA0 | |
| D09 | S0048880 | DIODE,D4SBS4 | |
| D13-D16 | S0059311 | DIODE,21DQ10 GA0 | |
| D17,D18 | S0053220 | DIODE,10EHA20 | |
| D19 | 5224592821 | ZENER DIO RD 33ESB1 FT | |
| D20 | 5224585621 | ZENER DIO RD6.2ESB1 FT | |
| D25-D32 | S0059311 | DIODE,21DQ10 GA0 | |
| D37-D40 | S0059311 | DIODE,21DQ10 GA0 | |
| F06 | E0034560 | CLIP FUSE,H0446 | |
| F06,F09 | E0077630 | T-LAG FUSE,2.0A IEC | |
| F09,F10 | E0034560 | CLIP FUSE,H0446 | |
| F10 | E0077850 | T-LAG FUSE,4.0A UL 125V | DM |
| F10 | E0077660 | T-LAG FUSE,4.0A IEC | EXP |
| F11,F12 | E0034560 | CLIP FUSE,H0446 | |
| F11,F12 | E0077630 | T-LAG FUSE,2.0A IEC | |
| P06 | 5336304400 | CONN PL B14B-EH W | |
| P07 | 5336249700 | CONN PL B07B-PH-K-S W | |
| P08 | 5336253700 | CONN PL B07B-PH-K-Y | |
| P09 | 5336304300 | CONN PL B13B-EH W | |
| P10 | 5336303200 | CONN PL B2B-EH W | |
| P11 | 5336303300 | CONN PL B3B-EH W | |
| P12 | 5336307300 | CONN PL B3B-EH-Y Y | |
| P14 | 5336303400 | CONN PL B4B-EH W | |
| P15 | 5336305400 | CONN PL B4B-EH-R R | |
| P17 | 5336249200 | CONN PL B02B-PH-K-S W | |
| POWER HEATSIN | B00170508A | SCREW,VPC 3*8 FZB G | |
| Q01 | 5230509100 | TR 2SB562 C | |
| R03,R04 | R0101341 | RD, 1/4W 10KOHM J | |
| R05 | R0101141 | RD, 1/4W 1.5KOHM J | |
| R06 | R0101321 | RD, 1/4W 8.2KOHM J | |
| R09 | R0101341 | RD, 1/4W 10KOHM J | |
| U02 | S0053740 | IC,BA08T | |
| U02,U04,U05 | M00350800B | HEATSINK,OSH-2435-SFL | |
| U04 | S0060430 | IC,PQ12RF11J00H GZX | |
| U05 | S0060420 | IC,PQ05RF11J00H GZX | |
| U06 | S0018843 | & IC,PQ05RR1 | |
| U07 | S0053810 | IC,BA15T | |
| U07,U08 | M00350800B | HEATSINK,OSH-2435-SFL | |
| U08 | 13447974 | IC LIN NJM7915FA | |
| U09 | S0060410 | IC,PQ30RV21J00H GZX | |
| U09,U11,U12 | M00350800B | HEATSINK,OSH-2435-SFL | |
| U11 | 13447971 | IC LIN NJM7908FA | |
| U12 | 13447954 | IC LIN NJM7808FA GZ0 | |
| W10-W13 | 5242117400 | JUMPER (INS) JPW-L5 | |
| W18,W19 | 5242117400 | JUMPER (INS) JPW-L5 | |

REG PCB ASSY

| REF. NO. | PARTS NUMBER | DESCRIPTION | REMARKS |
|----------|--------------|-------------------------|---------|
| | E95182400A | PCB ASSY,REG | |
| | E90182400A | PCB,REG | |
| C13,C15 | 5263167923 | C, FILM 0.10UF 50V J VT | |
| C68,C69 | 5263167923 | C, FILM 0.10UF 50V J VT | |
| P16 | 5336303800 | CONN PL B03B-PH-K-S WHT | |
| R01 | R0101181 | RD, 1/4W 2.2KOHM J | |
| R02 | R0101301 | RD, 1/4W 6.8KOHM J | |
| U01 | S0060420 | IC,PQ05RF11J00H GZX | |
| U03 | S0060410 | IC,PQ30RV21J00H GZX | |

PSW PCB ASSY

| REF. NO. | 品目コード | 品目テキスト | 備考 |
|----------|------------|-------------------------|------|
| | E95232400A | PCB ASSY,PSW UX-3 | |
| | E95232420A | PCB ASSY,PSW UX-3 T/C | |
| | E95232450A | PCB ASSY,PSW UX-3 EUR | |
| | E90182500B | PCB,PSW | |
| C01 | E0066080 | SPK KILLER,0.0047UF250V | |
| L01 | 5292806300 | FILTER, FKOB16MH13 | |
| P01 | 5336376200 | CONN PLUG B2P3-VH | |
| P02,P03 | 5336374600 | CONN PLUG B6P-VH | |
| SW1 | E0085700 | SW,PUSH SDKLA10300 | |
| W01 | 5181763000 | JUMPER P=10.0 | 100V |
| W02 | 5181763000 | JUMPER P=10.0 | 120V |
| W03 | 5181763000 | JUMPER P=10.0 | 230V |

INLET PCB ASSY

| REF. NO. | 品目コード | 品目テキスト | 備考 |
|----------|------------|---------------------|----|
| | E95232500A | PCB ASSY,INLET UX-3 | |
| | E90182600B | PCB,INLET | |
| | M01646300A | BRACKET,AC IN G-0 | |
| J01 | E0036070 | CONNECTOR,M1908-B | |
| J02 | 5336376200 | CONN PLUG B2P3-VH | |

DAC PCB ASSY

| REF. NO. | PARTS NUMBER | DESCRIPTION | REMARKS |
|-------------|--------------|---------------------------|---------|
| | E95223900A | PCB ASSY,DAC X-03 | |
| | E95223910A | PCB ASSY,DAC EXP X-03 | |
| | E90180900E | PCB,DAC 2CH | |
| | 5780202606 | SCREW, FLAT M2.6X6 | |
| | 5730039201 | HTSK,OSH-2425-SFL | |
| C1005,C1007 | C0007914 | CC, B 16V 0.10UF K 1608 | |
| C1006,C1016 | C0036174 | CE, 10V 33UF M SVP | |
| C1008 | C0036264 | CE, 10V 47UF M SVP | |
| C1009,C1011 | C0007914 | CC, B 16V 0.10UF K 1608 | |
| C1010,C1012 | C0036264 | CE, 10V 47UF M SVP | |
| C1013,C1015 | C0007914 | CC, B 16V 0.10UF K 1608 | |
| C1014,C1020 | C0036264 | CE, 10V 47UF M SVP | |
| C1017-C1019 | C0007914 | CC, B 16V 0.10UF K 1608 | |
| C1021 | C0007914 | CC, B 16V 0.10UF K 1608 | |
| C1022 | C0036174 | CE, 10V 33UF M SVP | |
| C1024 | C0036264 | CE, 10V 47UF M SVP | |
| C1101,C1103 | 5263167923 | C, FILM 0.10UF 50V J VT | |
| C1102,C1104 | C0007510 | CE, 16V 47UF M SA | |
| C1105,C1110 | 5263167923 | C, FILM 0.10UF 50V J VT | |
| C1106,C1111 | C0007510 | CE, 16V 47UF M SA | |
| C1107-C1109 | C0042652 | CE, 16V 100UF M LXZ | |
| C1112,C1114 | 5263167923 | C, FILM 0.10UF 50V J VT | |
| C1113,C1115 | C0007510 | CE, 16V 47UF M SA | |
| C1116,C1121 | 5263167923 | C, FILM 0.10UF 50V J VT | |
| C1117,C1122 | C0007510 | CE, 16V 47UF M SA | |
| C1118-C1120 | C0042652 | CE, 16V 100UF M LXZ | |
| C1123,C1125 | 5263167923 | C, FILM 0.10UF 50V J VT | |
| C1124,C1126 | C0035340 | CE, 16V 100UF M SA | |
| C1127,C1227 | C0044250 | CQ,630V 100PF J DTG GZO | |
| C1128,C1130 | 5263167923 | C, FILM 0.10UF 50V J VT | |
| C1129,C1131 | 5260473420 | CE, 100UF 25V M PZ VT | |
| C1132,C1232 | 5263312920 | C, FILM 0.0010UF 50V J VT | |
| C1133,C1233 | 5263311220 | CQ, 50V 200PF J VT | |
| C1134,C1136 | 5263167923 | C, FILM 0.10UF 50V J VT | |
| C1135,C1137 | C0035340 | CE, 16V 100UF M SA | |
| C1138,C1238 | 5263315320 | C, FILM 0.010UF 50V J VT | |
| C1139,C1239 | C0035340 | CE, 16V 100UF M SA | |
| C1140 | 5263310520 | C, FILM 100PF 50V J VT | |
| C1141,C1143 | 5263167923 | C, FILM 0.10UF 50V J VT | |
| C1142,C1144 | C0035340 | CE, 16V 100UF M SA | |
| C1145,C1146 | 5263310520 | C, FILM 100PF 50V J VT | |
| C1201,C1203 | 5263167923 | C, FILM 0.10UF 50V J VT | |
| C1202,C1204 | C0007510 | CE, 16V 47UF M SA | |
| C1205,C1210 | 5263167923 | C, FILM 0.10UF 50V J VT | |
| C1206,C1211 | C0007510 | CE, 16V 47UF M SA | |
| C1207-C1209 | C0042652 | CE, 16V 100UF M LXZ | |
| C1212,C1214 | 5263167923 | C, FILM 0.10UF 50V J VT | |
| C1213,C1215 | C0007510 | CE, 16V 47UF M SA | |
| C1216,C1221 | 5263167923 | C, FILM 0.10UF 50V J VT | |
| C1217,C1222 | C0007510 | CE, 16V 47UF M SA | |
| C1218-C1220 | C0042652 | CE, 16V 100UF M LXZ | |
| C1223,C1225 | 5263167923 | C, FILM 0.10UF 50V J VT | |
| C1224,C1226 | C0035340 | CE, 16V 100UF M SA | |
| C1228,C1230 | 5263167923 | C, FILM 0.10UF 50V J VT | |
| C1229,C1231 | 5260473420 | CE, 100UF 25V M PZ VT | |
| C1234,C1236 | 5263167923 | C, FILM 0.10UF 50V J VT | |
| C1235,C1237 | C0035340 | CE, 16V 100UF M SA | |
| C1240 | 5263310520 | C, FILM 100PF 50V J VT | |
| C1241,C1243 | 5263167923 | C, FILM 0.10UF 50V J VT | |
| C1242,C1244 | C0035340 | CE, 16V 100UF M SA | |
| C1245,C1246 | 5263310520 | C, FILM 100PF 50V J VT | |
| C1301,C1303 | 5263167923 | C, FILM 0.10UF 50V J VT | |
| C1302 | 5260531420 | CE, 100UF 20V M SA VT | |
| C1304 | C0042200 | CE, 25V 100UF M KZ | |
| C1307,C1308 | 5263167923 | C, FILM 0.10UF 50V J VT | |
| C1309,C1310 | 5260531420 | CE, 100UF 20V M SA VT | |
| C1311-C1314 | 5263167923 | C, FILM 0.10UF 50V J VT | |
| C1315,C1316 | 5260485000 | CE, 1000MF 16V ASF VE | |
| C1317,C1318 | 5263167923 | C, FILM 0.10UF 50V J VT | |
| C1319 | 5181761000 | JUMPER P=5.0 | |

DAC PCB ASSY

| REF. NO. | PARTS NUMBER | DESCRIPTION | REMARKS |
|--------------|--------------|---------------------------|---------|
| C1320 | 5242117400 | JUMPER (INS) JPW-L5 | |
| C1321,C1322 | 5263167923 | C, FILM 0.10UF 50V J VT | |
| C1321,C1322 | 5181761000 | JUMPER P=5.0 | |
| C1323 | 5263315320 | C, FILM 0.10UF 50V J VT | |
| C1501 | C0007914 | CC, B 16V 0.10UF K 1608 | |
| C1502 | C0036264 | CE, 10V 47UF M SVP | |
| C1508,C1511 | C0007914 | CC, B 16V 0.10UF K 1608 | |
| C1509,C1512 | C0007510 | CE, 16V 47UF M SA | |
| C1510 | C0040464 | CC,CH 50V 1000PF J 1608 | |
| C1513,C1519 | C0038234 | CC, B 10V 1.0UF K 1608 | |
| C1514 | C0004064 | CC,CH 50V 100PF J 1608 | |
| C1515,C1517 | C0007914 | CC, B 16V 0.10UF K 1608 | |
| C1516,C1532 | C0036174 | CE, 10V 33UF M SVP | |
| C1518,C1526 | C0036264 | CE, 10V 47UF M SVP | |
| C1520 | C0002244 | CC, B 50V 0.010UF K 1608 | |
| C1521 | C0035340 | CE, 16V 100UF M SA | |
| C1525,C1527 | C0007914 | CC, B 16V 0.10UF K 1608 | |
| C1528,C1530 | C0036264 | CE, 10V 47UF M SVP | |
| C1529,C1531 | C0007914 | CC, B 16V 0.10UF K 1608 | |
| C1533,C1535 | C0007914 | CC, B 16V 0.10UF K 1608 | |
| C1534 | C0036264 | CE, 10V 47UF M SVP | |
| C1536,C1538 | C0036264 | CE, 10V 47UF M SVP | |
| C1537 | C0007914 | CC, B 16V 0.10UF K 1608 | |
| C1601,C1603 | 5263167923 | C, FILM 0.10UF 50V J VT | |
| C1602 | 5260531420 | CE, 100UF 20V M SA VT | |
| C1604 | 5260485000 | CE, 1000MF 16V ASF VE | |
| C1605 | 5263167923 | C, FILM 0.10UF 50V J VT | |
| D1101,D1102 | 5224016420 | DIO S5688G TAPING | |
| D1201,D1202 | 5224016420 | DIO S5688G TAPING | |
| D1301-D1304 | S0059291 | DIODE,21DQ04 GAO | |
| DAC HEATSINK | B00170508A | SCREW,VPC 3*8 FZB G | |
| J1101 | E00353701A | JACK,RCA 1P WHITE NICKING | |
| J1102,J1202 | E0110250 | CONNECTOR,XLM-3-32PCV-F G | |
| J1201 | E00353801A | JACK,RCA 1P RED NICKING | |
| K1101,K1102 | 5290015600 | RLY A-12W-K | |
| K1201,K1202 | 5290015600 | RLY A-12W-K | |
| L1301-L1303 | 5286033920 | CHC 10UH K(LAP2T)VT | |
| L1501,L1603 | 5286033920 | CHC 10UH K(LAP2T)VT | |
| L1502 | 5286033920 | CHC 10UH K(LAP2T)VT | |
| L1601,L1602 | 5286033920 | CHC 10UH K(LAP2T)VT | |
| L1604,L1605 | 5286033920 | CHC 10UH K(LAP2T)VT | |
| P1001 | E0074674 | CONNECTOR,40FLT-SM1-TB | |
| P1003 | E0074663 | CONNECTOR,15FMN-BTK-A | |
| P1005 | 5336249300 | CONN PL B03B-PH-K-S W | |
| P1301,P1304 | 5336303200 | CONN PL B2B-EH W | |
| P1302,P1305 | 5336303300 | CONN PL B3B-EH W | |
| P1303,P1306 | 5336307300 | CONN PL B3B-EH-Y Y | |
| P1501 | 5336251200 | CONN PL B02B-PH-K-R R | |
| P1502 | 5336250000 | CONN PL B10B-PH-K-S W | |
| P1503 | 5336249200 | CONN PL B02B-PH-K-S W | |
| P1505 | 5336249600 | CONN PL B06B-PH-K-S W | |
| Q1101,Q1102 | 5232255620 | DTR DTC114ESA | |
| Q1201,Q1202 | 5232255620 | DTR DTC114ESA | |
| Q1601 | S0057224 | FET,MCH3306-TL-E GXX | |
| Q1602 | S0022044 | TRANSISTOR,DTC114EUA-T106 | |
| R1001-R1003 | R0015454 | RD,1/16W 47 OHM J | |
| R1028-R1031 | R0015454 | RD,1/16W 47 OHM J | |
| R1032,R1045 | 11986738 | CHIP JUMPER (1.6*0.8) | |
| R1033,R1034 | 11986493 | RES RD 1/16W 24OHM 5% | |
| R1036 | 11986493 | RES RD 1/16W 24OHM 5% | |
| R1037 | R0016174 | RD,1/16W 47KOHM J | |
| R1038 | 11986499 | RES RD 1/16W 43OHM 5% | |
| R1039-R1043 | R0132464 | RD,1/16W 47 OHM G 1608A | |
| R1046,R1047 | R0015454 | RD,1/16W 47 OHM J | |
| R1050,R1051 | R0016174 | RD,1/16W 47KOHM J | |
| R1052-R1055 | 11986738 | CHIP JUMPER (1.6*0.8) | |
| R1101,R1102 | R0100461 | RD, 1/4W 2.2 OHM J | |
| R1103,R1203 | R0108681 | RN, 1/4W 1.5KOHM F L=10 | |
| R1104,R1105 | R0100461 | RD, 1/4W 2.2 OHM J | |
| R1106-R1108 | R0108801 | RN, 1/4W 4.7KOHM F L=10 | |

DAC PCB ASSY

| REF. NO. | PARTS NUMBER | DESCRIPTION | REMARKS |
|-------------|--------------|--------------------------|---------|
| R1109,R1110 | R0100461 | RD, 1/4W 2.2 OHM J | |
| R1111-R1114 | R0108871 | RN, 1/4W 9.1KOHM F L=10 | |
| R1115 | R0108481 | RN, 1/4W 220 OHM F L=10 | |
| R1117,R1118 | 5286033920 | CHC 10UH K(LAP2T)VT | |
| R1119-R1122 | R0108871 | RN, 1/4W 9.1KOHM F L=10 | |
| R1123,R1129 | R0108511 | RN, 1/4W 300 OHM F L=10 | |
| R1125-R1128 | R0108871 | RN, 1/4W 9.1KOHM F L=10 | |
| R1131,R1231 | R0109041 | RN, 1/4W 47KOHM F L=10 | |
| R1201,R1202 | R0100461 | RD, 1/4W 2.2 OHM J | |
| R1204,R1205 | R0100461 | RD, 1/4W 2.2 OHM J | |
| R1206-R1208 | R0108801 | RN, 1/4W 4.7KOHM F L=10 | |
| R1209,R1210 | R0100461 | RD, 1/4W 2.2 OHM J | |
| R1211-R1214 | R0108871 | RN, 1/4W 9.1KOHM F L=10 | |
| R1215 | R0108481 | RN, 1/4W 220 OHM F L=10 | |
| R1217,R1218 | 5286033920 | CHC 10UH K(LAP2T)VT | |
| R1219-R1222 | R0108871 | RN, 1/4W 9.1KOHM F L=10 | |
| R1223,R1229 | R0108511 | RN, 1/4W 300 OHM F L=10 | |
| R1225-R1228 | R0108871 | RN, 1/4W 9.1KOHM F L=10 | |
| R1501,R1502 | R0015574 | RD,1/16W 150 OHM J | |
| R1504 | R0015454 | RD,1/16W 47 OHM J | |
| R1508,R1526 | R0015454 | RD,1/16W 47 OHM J | |
| R1510 | R0015454 | RD,1/16W 47 OHM J | |
| R1511,R1512 | R0015534 | RD,1/16W 100 OHM J | |
| R1513 | R0016114 | RD,1/16W 27KOHM J | |
| R1514,R1515 | R0129354 | RD,1/16W 1.0KOHM D 1608 | |
| R1516 | R0015774 | RD,1/16W 1.0KOHM J | |
| R1518 | R0132464 | RD,1/16W 47 OHM G 1608A | |
| R1519 | R0015534 | RD,1/16W 100 OHM J | |
| R1520,R1522 | R0132464 | RD,1/16W 47 OHM G 1608A | |
| R1521,R1523 | R0016174 | RD,1/16W 47KOHM J | |
| R1527 | R0016014 | RD,1/16W 10KOHM J | |
| R1528,R1529 | R0015774 | RD,1/16W 1.0KOHM J | |
| R1530-R1532 | R0016014 | RD,1/16W 10KOHM J | |
| R1533,R1534 | R0016174 | RD,1/16W 47KOHM J | |
| R1601 | 11986580 | RESISTOR RD 1/16W 100K J | |
| R1602 | 11986524 | RESISTOR RD 1/16W 470 J | |
| U1002,U1005 | S0053144 | IC,TC74VHC157FT | |
| U1003 | S0053193 | IC,SM5847AF | |
| U1004,U1510 | S0053204 | IC,BU2288FV-E2 | |
| U1006 | S0053154 | IC,TC74VHC04FT | |
| U1007 | S0053164 | IC,TC74VHCT08AFT | |
| U1008 | S0051944 | IC,TC74VHC74FT | |
| U1009 | S0053164 | IC,TC74VHCT08AFT | |
| U1101,U1102 | S0037410 | IC,PCM1704U | |
| U1103,U1104 | S0060214 | IC,AD825ARZ-REEL7 GAX | |
| U1105,U1205 | S0058820 | IC,OP42GP | |
| U1106,U1206 | S0049770 | IC,LM6172IN | |
| U1201,U1202 | S0037410 | IC,PCM1704U | |
| U1203,U1204 | S0060214 | IC,AD825ARZ-REEL7 GAX | |
| U1301,U1304 | 13447952 | IC LIN NJM7805FA | |
| U1302,U1602 | S0051390 | IC,NJU7223F33 | |
| U1305 | 13447969 | IC LIN NJM7905FA | |
| U1306 | 13447956 | IC LIN NJM7812FA GZ0 | |
| U1307 | 13447973 | IC LIN NJM7912FA | |
| U1501 | S0053114 | IC,TC7SET08F | |
| U1505 | 5220123500 | IC DGTL MC74HC4046AFEL G | |
| U1506 | S0053134 | IC,TC7WHU04FU | |
| U1507 | S0034844 | IC,TC74HC4053AFT(EL) | |
| U1508 | E01018500A | VCXO,VA524A 27.00MHZ GXX | |
| U1511 | S0053174 | IC,TC74VHC86FT | |
| U1512 | S00539000B | IC,WORD PLL V1.10 | |
| U1601 | 13447952 | IC LIN NJM7805FA | |
| W1005,W1008 | 5242117400 | JUMPER (INS) JPW-L5 | |
| W1010 | 5242117400 | JUMPER (INS) JPW-L5 | |
| W1104,W1106 | 5242117400 | JUMPER (INS) JPW-L5 | |
| W1108 | 5242117400 | JUMPER (INS) JPW-L5 | |
| W1204,W1206 | 5242117400 | JUMPER (INS) JPW-L5 | |
| W1208 | 5242117400 | JUMPER (INS) JPW-L5 | |
| W1301 | 5242117400 | JUMPER (INS) JPW-L5 | |
| W1601 | 5242117400 | JUMPER (INS) JPW-L5 | |

1394 BVF PCB ASSY

| REF. NO. | PARTS NUMBER | DESCRIPTION | REMARKS |
|-------------|--------------|---------------------------|---------|
| | E95229900A | PCB ASSY,1394 BVF | |
| | E90229900A | PCB,1394 BVF | |
| | M02009600A | HEATSINK,1394 UX3 | |
| HEATSINK | B00171412A | SCREW,BPA 3*12 FZB G | |
| HEATSINK | M0126810 | NUT,ST1 A M3 6 S NI | |
| C1012 | 12911308 | CAPACITOR CC25V F0.10UF Z | |
| C1013,C1014 | 12911308 | CAPACITOR CC25V F0.10UF Z | |
| C1016,C1017 | 12910307 | CAP CC50V B10000PF K | |
| C1020 | C0001674 | CC,CH 50V 220PF J 1608 | |
| C1022,C1308 | C0037404 | CC, B 16V 1UF M | |
| C1026,C1030 | C0037294 | CS, 6.3V 47UF M 3528 | |
| C1027,C1028 | 12911308 | CAPACITOR CC25V F0.10UF Z | |
| C1029,C1031 | 12911308 | CAPACITOR CC25V F0.10UF Z | |
| C1032,C1042 | C0040464 | CC,CH 50V 1000PF J 1608 | |
| C1033,C1034 | C0001394 | CC,CH 50V 15PF J 1608 | |
| C1035,C1041 | 12911308 | CAPACITOR CC25V F0.10UF Z | |
| C1043,C1045 | 12911308 | CAPACITOR CC25V F0.10UF Z | |
| C1044,C1046 | C0040464 | CC,CH 50V 1000PF J 1608 | |
| C1047,C1051 | 12911308 | CAPACITOR CC25V F0.10UF Z | |
| C1048,C1062 | C0040464 | CC,CH 50V 1000PF J 1608 | |
| C1052,C1102 | C0037294 | CS, 6.3V 47UF M 3528 | |
| C1053-C1058 | 12911308 | CAPACITOR CC25V F0.10UF Z | |
| C1061,C1067 | 12911308 | CAPACITOR CC25V F0.10UF Z | |
| C1063,C1064 | C0040464 | CC,CH 50V 1000PF J 1608 | |
| C1065,C1066 | C0040464 | CC,CH 50V 1000PF J 1608 | |
| C1068,C1101 | 12911308 | CAPACITOR CC25V F0.10UF Z | |
| C1103,C1111 | 12911308 | CAPACITOR CC25V F0.10UF Z | |
| C1112,C1113 | 12911308 | CAPACITOR CC25V F0.10UF Z | |
| C1151-C1153 | 12911308 | CAPACITOR CC25V F0.10UF Z | |
| C1302 | C0025384 | CE, 16V 100UF M | |
| C1303 | 12911308 | CAPACITOR CC25V F0.10UF Z | |
| C1304 | C0036314 | CE,6.3V 100UF M SVP | |
| C1307 | 12911308 | CAPACITOR CC25V F0.10UF Z | |
| C1309,C1310 | 12911308 | CAPACITOR CC25V F0.10UF Z | |
| C1311 | C0037294 | CS, 6.3V 47UF M 3528 | |
| C1312 | 12911308 | CAPACITOR CC25V F0.10UF Z | |
| C1313,C1314 | C0001394 | CC,CH 50V 15PF J 1608 | |
| C1315-C1321 | 12911308 | CAPACITOR CC25V F0.10UF Z | |
| D1302 | S0022094 | DIODE,1SS355 | |
| FL1001 | E0082904 | COIL,944CM-0004 GB0 | |
| FL1001 | M02010800A | SHEET,EWA T2 3*4 | |
| FL1301 | E0095854 | COIL,ACM0706-102-2P-T GXX | |
| J1001 | E0095950 | CN,MV6SS50SSN-B31(LF) GX0 | |
| J1101 | 5336249300 | CONN PL B03B-PH-K-S W | |
| J1102 | E0074674 | CONNECTOR,40FLT-SM1-TB | |
| J1151 | 5336386600 | CONN PL 6P B6BZRSM3TF | |
| J1301 | 5336303200 | CONN PL B2B-EH W | |
| J1302 | E0047044 | CONNECTOR,B10B-ZR-SM3-TF | |
| J1303 | 5336249400 | CONNECTORPLUG B04B-PH-K-S | |
| J1304 | 5336249900 | CONN PL B09B-PH-K-S W | |
| L1003,L1004 | E0033204 | BEAD COIL,BLM11P300S | |
| L1006 | E0075424 | COIL,FSLB2520-4R7M GAX | |
| L1007,L1008 | E0075424 | COIL,FSLB2520-4R7M GAX | |
| L1101,L1301 | E0075424 | COIL,FSLB2520-4R7M GAX | |
| Q1301,Q1302 | S0036084 | TRANSISTOR,DTC114YKA | |
| R1011 | R0067304 | RES ARRAY,1/16W 4*10K J | |
| R1012 | 11990140 | RN,1/10W 5.1K OHM F 1608 | |
| R1013-R1016 | R0009194 | RD,1/16W 56 OHM F | |
| R1027 | 11990362 | RN,1/10W 6.34K OHM F 1608 | |
| R1030-R1034 | R0067304 | RES ARRAY,1/16W 4*10K J | |
| R1035,R1038 | 11986532 | RESISTOR RD 1/16W 1.0K J | |
| R1101 | 11990153 | RN,1/10W 18K OHM F 1608 | |
| R1102,R1106 | 11986500 | RES RD 1/16W 47OHM 5% | |
| R1107,R1117 | 11986532 | RESISTOR RD 1/16W 1.0K J | |
| R1118,R1311 | 11986556 | RESISTOR RD 1/16W 10K J | |
| R1121,R1122 | R0066704 | RES ARRAY,1/16W 4*33 J | |
| R1123,R1131 | R0066704 | RES ARRAY,1/16W 4*33 J | |
| R1125 | 11986496 | RESISTOR RD 1/16W 33 J | |
| R1126 | 11986496 | RESISTOR RD 1/16W 33 J | |
| R1132,R1133 | R0066704 | RES ARRAY,1/16W 4*33 J | |

1394 BVF PCB ASSY

| REF. NO. | PARTS NUMBER | DESCRIPTION | REMARKS |
|-------------|--------------|---------------------------|---------|
| R1151 | 11986500 | RES RD 1/16W 47OHM 5% | |
| R1152,R1319 | R0067304 | RES ARRAY,1/16W 4*10K J | |
| R1171 | 11986500 | RES RD 1/16W 47OHM 5% | |
| R1172 | 11986548 | RESISTOR RD 1/16W 4.7K J | |
| R1173,R1301 | 11986532 | RESISTOR RD 1/16W 1.0K J | |
| R1174-R1177 | 11986500 | RES RD 1/16W 47OHM 5% | |
| R1178 | 11986556 | RESISTOR RD 1/16W 10K J | |
| R1302 | 11986540 | RESISTOR RD 1/16W 2.2K J | |
| R1304 | 11986520 | RES RD 1/16W 330OHM 5% | |
| R1306 | R0016334 | RD,1/16W 220KOHM J | |
| R1307 | 11986540 | RESISTOR RD 1/16W 2.2K J | |
| R1308,R1330 | 11986564 | RES RD 1/16W 22KOHM 5% | |
| R1312,R1313 | 11986532 | RESISTOR RD 1/16W 1.0K J | |
| R1321,R1323 | 11986556 | RESISTOR RD 1/16W 10K J | |
| R1322 | 11986532 | RESISTOR RD 1/16W 1.0K J | |
| R1324 | 11986532 | RESISTOR RD 1/16W 1.0K J | |
| R1325 | R0067304 | RES ARRAY,1/16W 4*10K J | |
| R1326 | 11986556 | RESISTOR RD 1/16W 10K J | |
| R1331 | 11986564 | RES RD 1/16W 22KOHM 5% | |
| R1332,R1334 | 11986532 | RESISTOR RD 1/16W 1.0K J | |
| R1333,R1335 | 11986500 | RES RD 1/16W 47OHM 5% | |
| R1336 | 11986532 | RESISTOR RD 1/16W 1.0K J | |
| R1337 | 11986532 | RESISTOR RD 1/16W 1.0K J | |
| R1338 | 11986532 | RESISTOR RD 1/16W 1.0K J | |
| U1007 | S0059283 | IC,TSB43CA42PGFG4 GA0 | |
| U1101 | S0053004 | IC,AK4112BVF-E2 | |
| U1102 | S0057034 | IC,SN74CBTLV3257PWR GXX | |
| U1105 | S0057044 | IC,SN74AHC1GU04DCK GXX | |
| U1109,U1110 | S0049493 | IC,TC74VHC541FT TSSOP | |
| U1151 | S00584900A | IC,SIF PLD BVF V1.00 | |
| U1302 | S0060310 | IC,PQ3RF33J GZO | |
| U1304 | S0052944 | IC,TC7SET08FU(TE85L) | |
| U1305 | S0057054 | IC,M62705ML GXX | |
| U1306 | S00571500C | IC,ROM SIF V1.11 | |
| U1307 | S00571400C | IC,MPU SIF V1.11 | |
| U1308 | S0057044 | IC,SN74AHC1GU04DCK GXX | |
| X1001 | E0095504 | RESONATOR,LIM55A-T24M GXX | |
| X1301 | E0095494 | RESONATOR,LIM55A-T16M GXX | |

DATA JCT PCB ASSY

| REF. NO. | PARTS NUMBER | DESCRIPTION | REMARKS |
|---------------|--------------|-------------------------|---------|
| | E95231600A | PCB ASSY,DATA JCT | |
| | E90231600A | PCB,DATA JCT | |
| | E0095420 | TERMINAL,M1866-A GZO | |
| C3001,C3003 | C0007914 | CC, B 16V 0.10UF K 1608 | |
| C3002,C3004 | C0036264 | CE, 10V 47UF M SVP | |
| C3005,C3007 | C0007914 | CC, B 16V 0.10UF K 1608 | |
| C3006,C3008 | C0036264 | CE, 10V 47UF M SVP | |
| C3009 | C0007914 | CC, B 16V 0.10UF K 1608 | |
| C3010 | C0036264 | CE, 10V 47UF M SVP | |
| C3012,C3013 | C0007914 | CC, B 16V 0.10UF K 1608 | |
| P3001 | 13124424 | CONNECTOR ZH B 2B-ZR | |
| P3002-P3004 | E0074674 | CONNECTOR,40FLT-SM1-TB | |
| R3004-R3010 | 11986500 | RES RD 1/16W 47OHM 5% | |
| R3014-R3034 | 11986500 | RES RD 1/16W 47OHM 5% | |
| R3035,C3011 | 11986738 | CHIP JUMPER (1.6*0.8) | |
| R3036-R3044 | 11986500 | RES RD 1/16W 47OHM 5% | |
| R3045 | R0016014 | RD,1/16W 10KOHM J | |
| RA3003-RA3006 | R0066744 | RES ARRAY,1/16W 4*47 J | |
| RA3009-RA3012 | R0066744 | RES ARRAY,1/16W 4*47 J | |
| U3002-U3004 | S0049493 | IC,TC74VHC541FT TSSOP | |

INCLUDED ACCESSORIES

| REF. NO. | PARTS NUMBER | DESCRIPTION | REMARKS |
|----------|--------------|----------------------------|---------|
| | E00309700E | POWER CORD,SET 2P DM | DM |
| | E0093270 | POWER CORD,3CUL 34895 VEL | T/C |
| | 15922303 | CORD, SET 3P (0306B-0303B) | EUR,KOR |
| | E00857900A | RMT CONT,RC-941 X-01 | |
| | S0059183 | IC,S0102 | |
| | M01542200A | PAD,KEY | |
| | 5347006900 | C-BATTERY JPN | DM |
| | 5347007000 | C-BATTERY ENG | EXP |
| | D00867500A | WARR CARD,T/C E/F ESO | T/C |
| | D00867400B | WARR CARD,EUR/KOR E/F ESO | EUR,KOR |
| | D00797600 | POSTCARD,USER A () | DM |
| | D00856200B | OWNERS MNL,DM X-03 | DM |
| | D00819900A | DISTRIBUTOR LIST,WORLD | EXP |
| | D00864300A | OWNERS MNL,ENGLISH X-03 | EXP |
| | M01499300A | CUSHION,FOOT 40 | |
| | J0079750 | SCRERWDRIVER,NDV-5+ | EXP |
| | M02109900A | SHEET,INFO PROTECTION | DM |

PACKAGE

| REF. NO. | PARTS NUMBER | DESCRIPTION | REMARKS |
|----------|--------------|--------------------------|---------|
| | Y00271500B | SET PACKAGE,X-03 | DM |
| | Y00271510B | SET PACKAGE,EXP X-03 | EXP |
| | M00743800B | POLTHN SHEET,1350*640 | |
| | M01972900A | BAG,NO-WOVEN 430*430*170 | |
| | M00481200B | SILICAGEL,DA-38 | |
| | M01555400A | POLTHN SHEET,AIR 600X350 | |
| | 5725192901 | PROTECTOR, COPPER | |
| | M0197610 | JOINT,HANDLE PP-901WP2 | |